



High Street, BR3 | £410,000

02087029999

newhomes@pedderproperty.com

pedder
NEW HOMES



In General

- Brand New Development
- Private Balcony
- 10-year Structural Warranty
- Open-plan Kitchen/Living area
- Herringbone Flooring
- Parking available via separate negotiation
- Air Source Heat Pump
- Central Beckenham
- Close to Kelsey Park
- Quick connection to Central London

In Detail

Kelsey House is a brand-new development of nine 1, 2 and 3 bedroom luxury apartments. Each with private outside space and parking available.



Floorplan

Kelsey House, BR3

Approximate Gross Internal Area
52.7 sq m / 567 sq ft

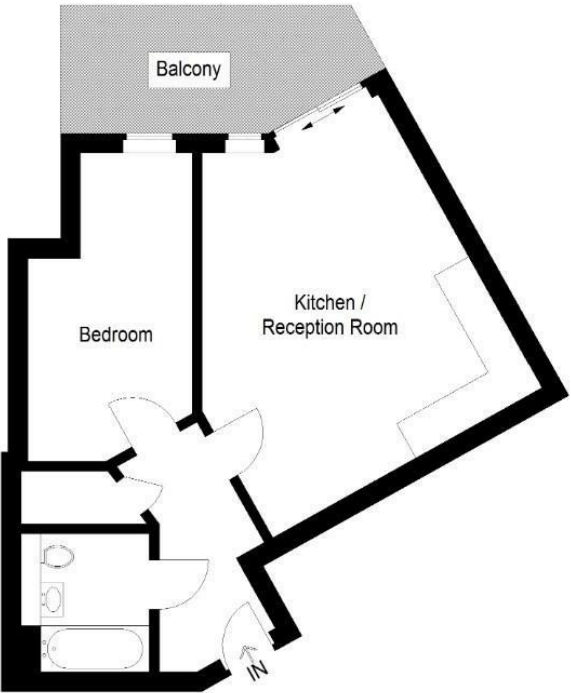

Second Floor

Copyright www.pedderproperty.com © 2025
These plans are for representation purposes only
as defined by RICS - Code of Measuring Practice.
Not drawn to Scale. Windows and door openings
are approximate. Please check all dimensions,
shapes and compass bearings before making
any decisions reliant upon them.

Energy Efficiency Rating		
Very energy efficient - lower running costs	Current	Potential
102 plus) A		
(81-101) B		
(69-80) C		
(55-68) D		
(39-54) E		
(21-38) F		
(1-20) G		
Not energy efficient - higher running costs		
England & Wales		
EU Directive 2002/91/EC		

Pedder Property Ltd trading as Pedder for themselves and for the vendor/landlord of this property whose agents they are, give notice that (1) these particulars do not constitute any part of an offer or contract, (2) all statements contained within these particulars are made without responsibility on the part of Pedder or the vendor/landlord, (3) whilst made in good faith, none of the statements contained within these particulars are to be relied upon as a statement of representation or fact, (4) any intending purchaser/tenant must satisfy him/herself by inspection or otherwise as to the correctness of each of the statements contained within these particulars, (5) the vendor/landlord does not make or give either Pedder or any person in their employment any authority to make or give representation or warranty whatsoever in relation to this property.